

RantCell User QoE test Report



OperatorName	40445_AIRTEL
Test phone Model/Models	Samsung SM-M325F
Report Generation Time	Apr 8, 2024 4:13:36 PM
Test StartTime	Apr 8, 2024 3:13:41 PM
Test EndTime	Apr 8, 2024 4:10:48 PM
Floor Plan Name	castle2
Floor ID	1
Ping Test	Yes
Http Download Speed Test	Yes
Http Upload Speed Test	Yes
Voice Call Test	Yes

Latency test report

Latency test view (Ping Test) for 40445_AIRTEL



Floor Plan Name : castle2 Floor ID : 1



Latency KPI statistics per mobile operator for 40445_AIRTEL

Latency	Airtel (40445)
0ms - 120ms	100.0000 % (count : 8)
>= 121ms	0 % (count : 0)
Dropped Packets	0 % (count : 0)
Highest Latency (ms)	49
Lowest Latency (ms)	26
Total Geo samples	8

HttpDownload speed test report

HttpDownload speed test view for 40445_AIRTEL



Floor Plan Name : castle2 Floor ID : 1



HttpDownload test KPI statistics per mobile operator for 40445_AIRTEL

Http Download Speed	Airtel (40445)
above 1.2Mbps	100.0000 % (count : 50)
0.4Mbps - 1.19Mbps	0 % (count : 0)
0Mbps - 0.39Mbps	0 % (count : 0)
Average (mbps)	2.15
Peak Speed (mbps)	5.85
Lowest Recorded (mbps)	1.62
Total Geo samples	50

HttpUpload speed test report

HttpUpload speed test view for 40445_AIRTEL



Floor Plan Name : castle2 Floor ID : 1

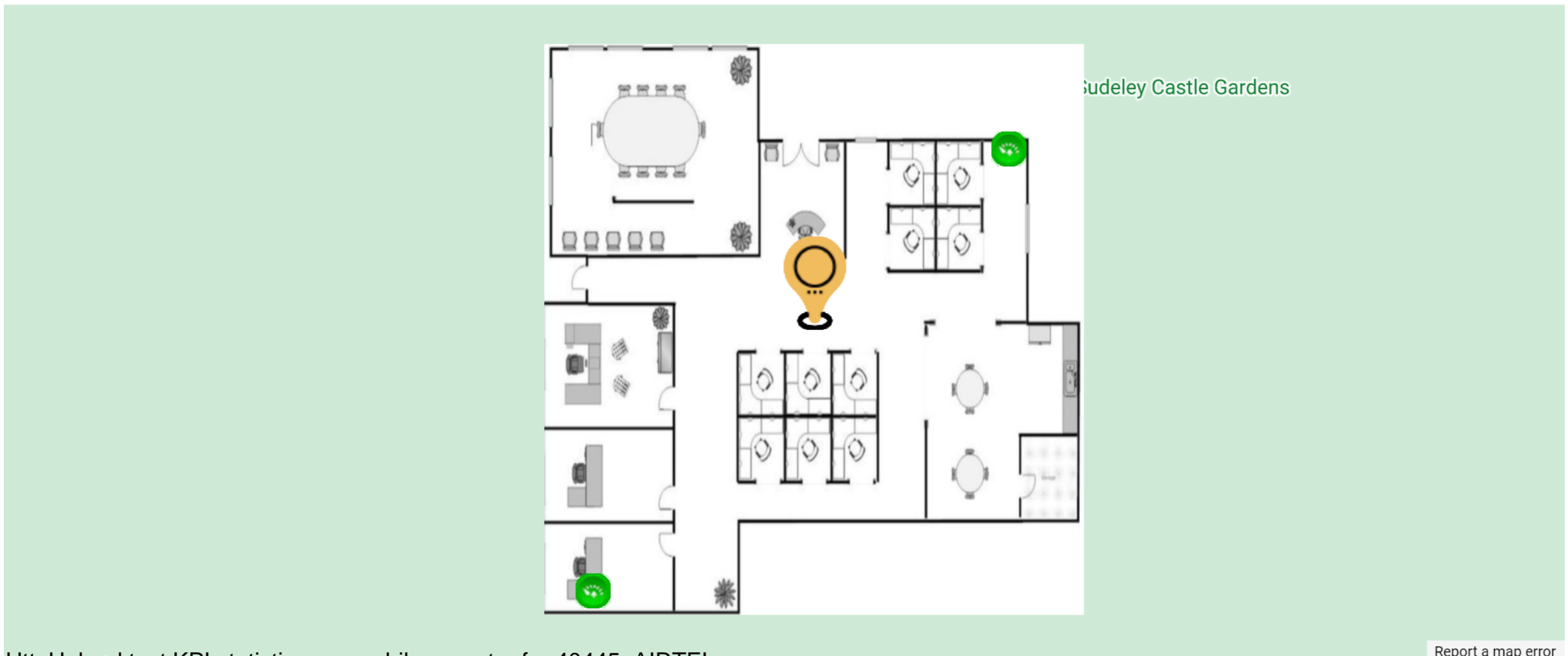

[Report a map error](#)

HttpUpload test KPI statistics per mobile operator for 40445_AIRTEL

Operators	Airtel (40445)
above 0.5Mbps	100.0000 % (count : 50)
0.2Mbps - 0.49Mbps	0 % (count : 0)
0Mbps - 0.19Mbps	0 % (count : 0)
Average (mbps)	4.56
Peak Speed (mbps)	8.11
Lowest Recorded (mbps)	2.8
Total Geo samples	50

Voice call test report

Call test view of mobile operators for 40445_AIRTEL

Floor Plan Name : castle2 Floor ID : 1

Call Setup
Call in Progress
Call disconnected
Call Dropped
Call Aborted
Call Setup Failure
No Network

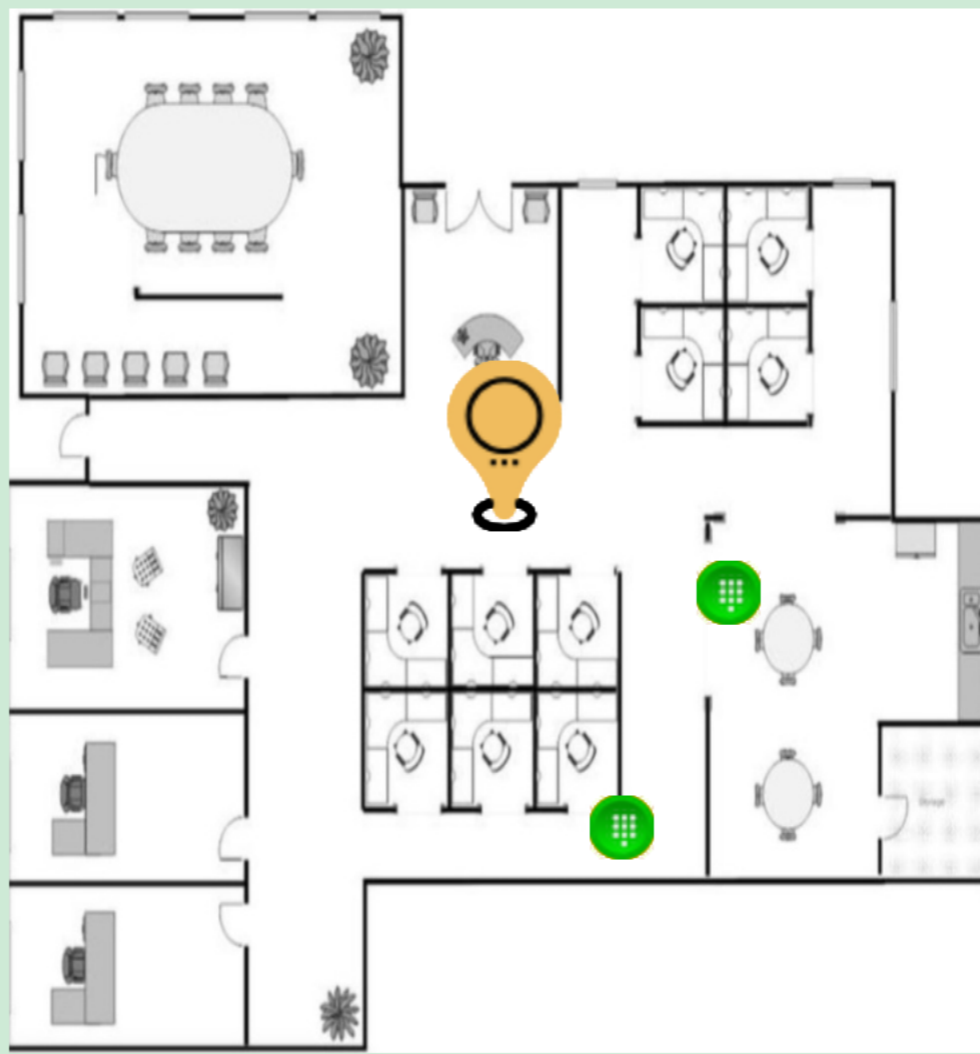

Report a map error

Call test KPI statistics per mobile operator for 40445_AIRTEL

Call Setup Time	Airtel (40445)
(0 to 4.5secs)	0 % (count : 0)
Bw(4.5 to 6.5secs)	100.0000 % (count : 2)
(> 6.6secs)	0 % (count : 0)
Highest Setup Time (sec)	5.6
Lowest Setup Time (sec)	4.93
Total Geo samples	37
Total Calls Success	2
Total Calls Attempted	2
Total Calls Failed	0
Dropped Calls	0
Aborted Calls	0
CallSetup Failed	0
No Network ?	0
Attempted Voice call on 2G ?	0
Attempted Voice call on 3G ?	0
Attempted Voice call on 4G (VoLTE) ?	2
Attempted Voice call on 2G/3G ?	0
Attempted Voice call on 3G/2G ?	0
Successful CSFB call to 2G ?	0
Successful CSFB call to 3G ?	0
SRVCC call to 3G ?	0
SRVCC call to 2G ?	0
CSFB call to 2G Failed ?	0
CSFB call to 3G Failed ?	0
Not Determined(Voice CallType) ?	0
Voice call on vo-Wifi	0

User perceived mobile network coverage during tests

mobile network coverage during tests for operators 40445_AIRTEL



Floor Plan Name :

castle2

Floor ID :

1



RAN technology statistics per mobile network operator for 40445_AIRTEL

Network Type	Airtel (40445)
5G	0.0000%
4G	100.0000%
3G	0.0000%
2G	0.0000%
CDMA	0.0000%
NONETWORK	0.0000%
Total Geo samples	674

User perceived RAN technology data connectivity statistics

Mobile data connectivity during tests for operator 40445_AIRTEL



Floor Plan Name : castle2 Floor ID : 1

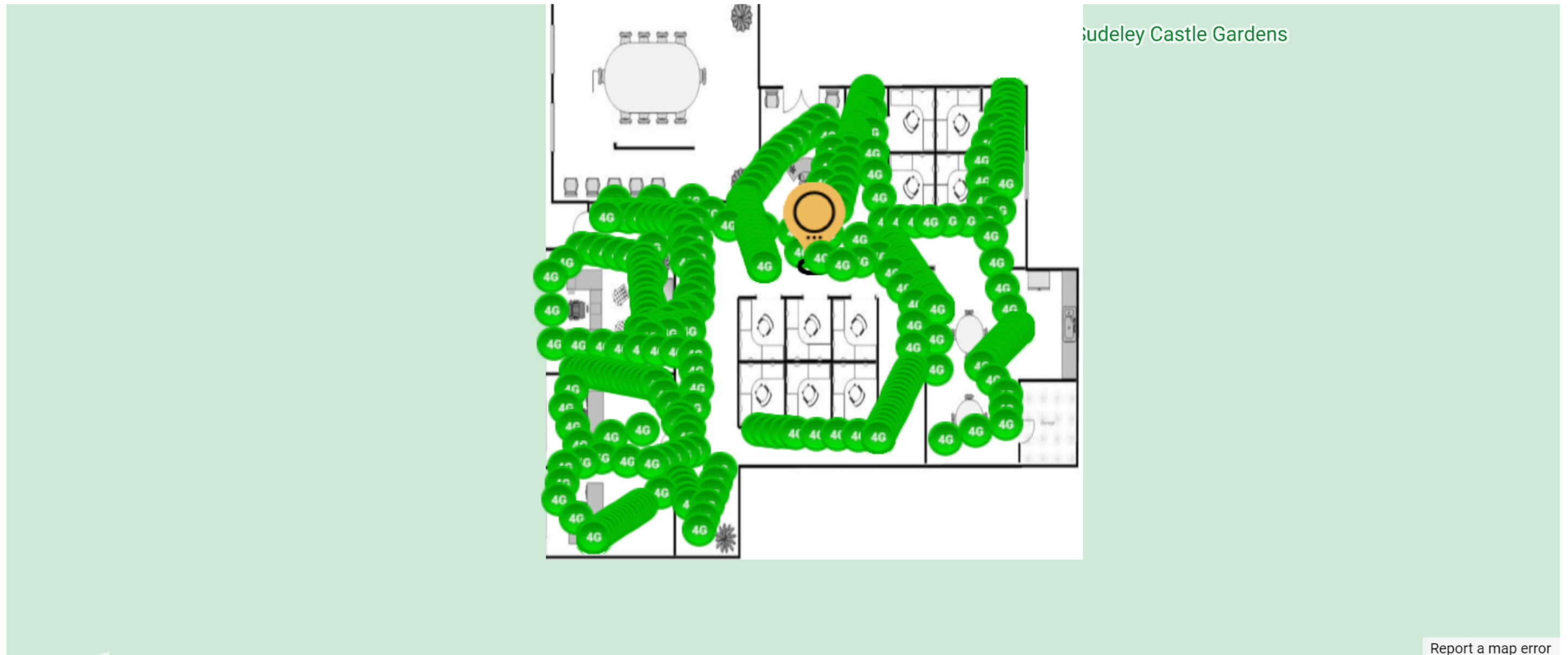

[Report a map error](#)

Data connectivity statistics per Mobile network operator for 40445_AIRTEL

Data Type	Airtel (40445)
5G	0.0000%
4G	100.0000%
3G	0.0000%
2G	0.0000%
CDMA	0.0000%
WIFI	0.0000%
NODATA	0.0000%
Total Geo samples	674

Floor Plan Name : castle2 Floor ID : 1

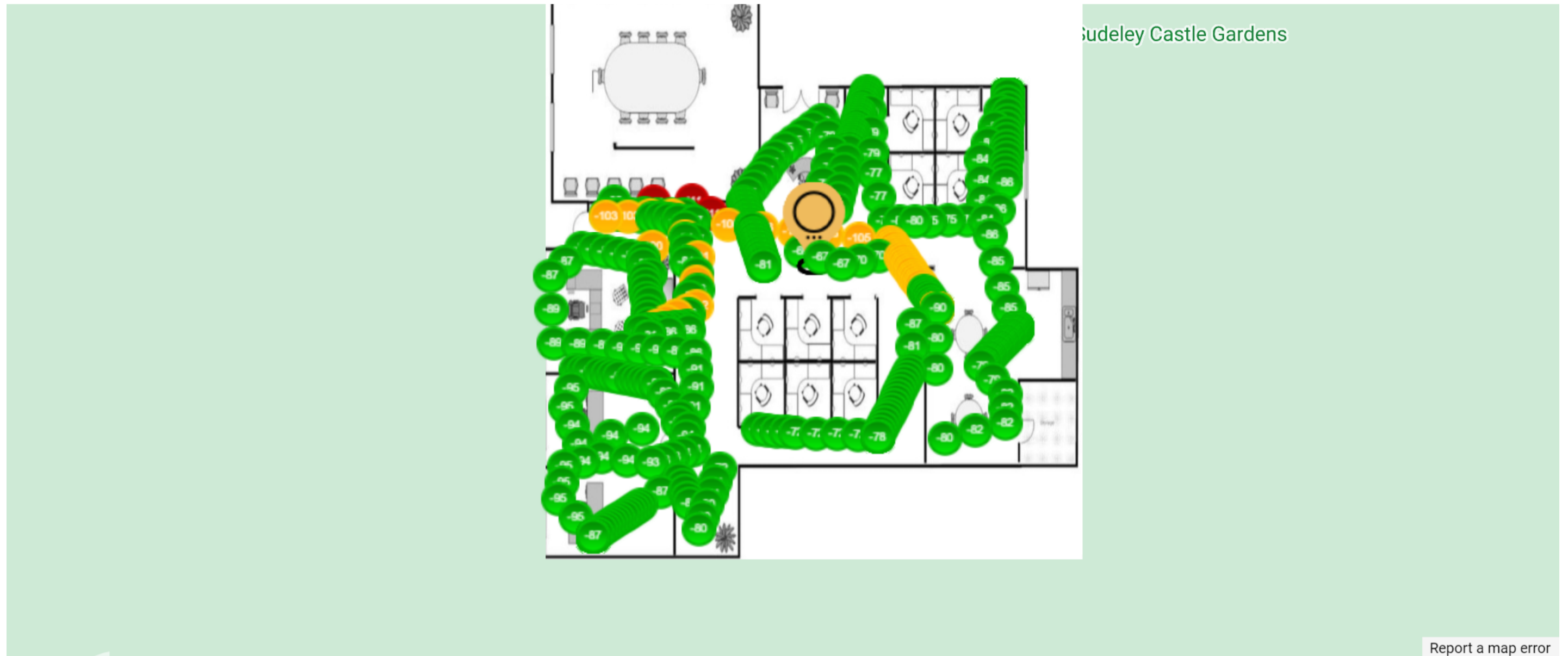

[Report a map error](#)

IteRSRP KPI statistics per mobile operator for 40445_AIRTEL

RSRP	Airtel (40445)
>= to -99dBm	92.4471 % (count : 612)
B/w -106dBm to -100dBm	7.0997 % (count : 47)
B/w -111dBm to -107dBm	0.4532 % (count : 3)
<= -112dBm	0 % (count : 0)
Total Geo samples	662

Floor Plan Name : castle2 Floor ID : 1

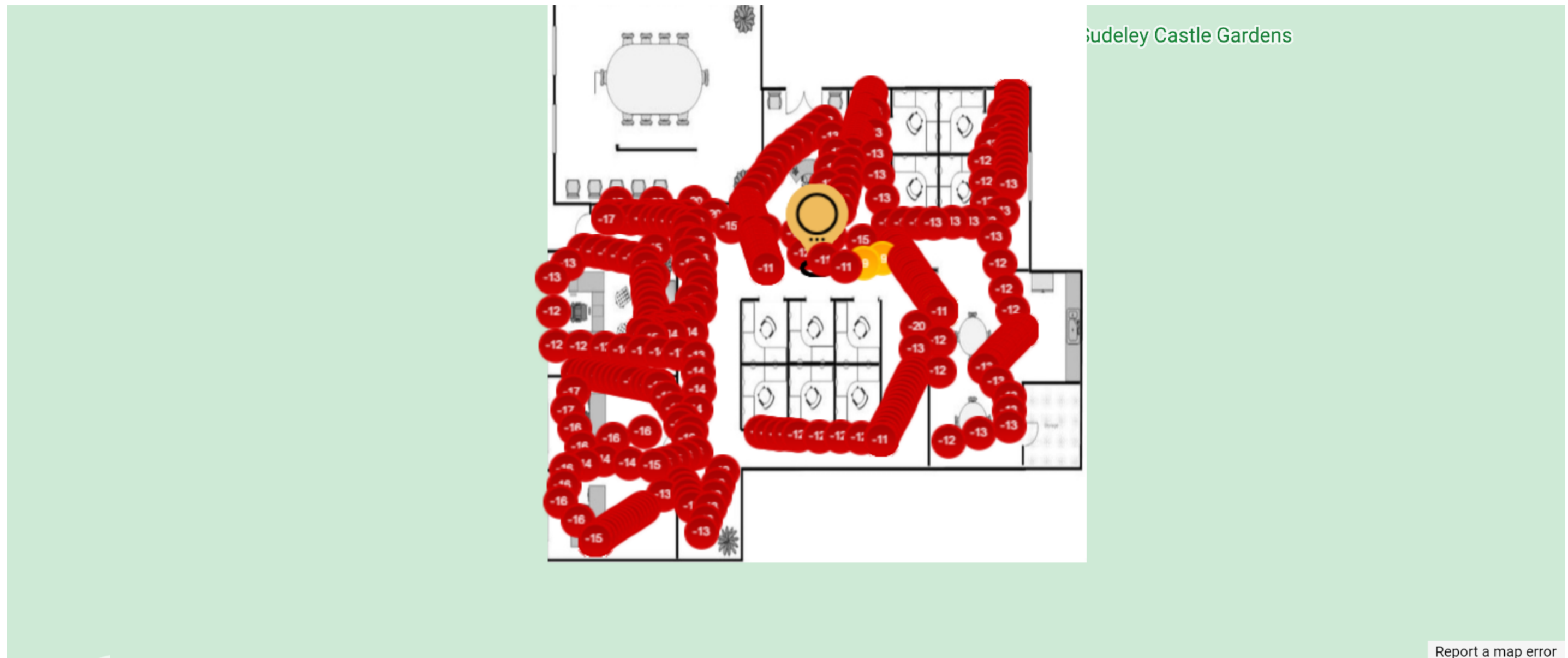

[Report a map error](#)

IteRSRQ KPI statistics per mobile operator for 40445_AIRTEL

RSRQ	Airtel (40445)
>= to -7dB	0 % (count : 0)
B/w -8dB to -9dB	1.2085 % (count : 8)
<= -10dB	98.7915 % (count : 654)
Total Geo samples	662

Floor Plan Name : castle2 Floor ID : 1

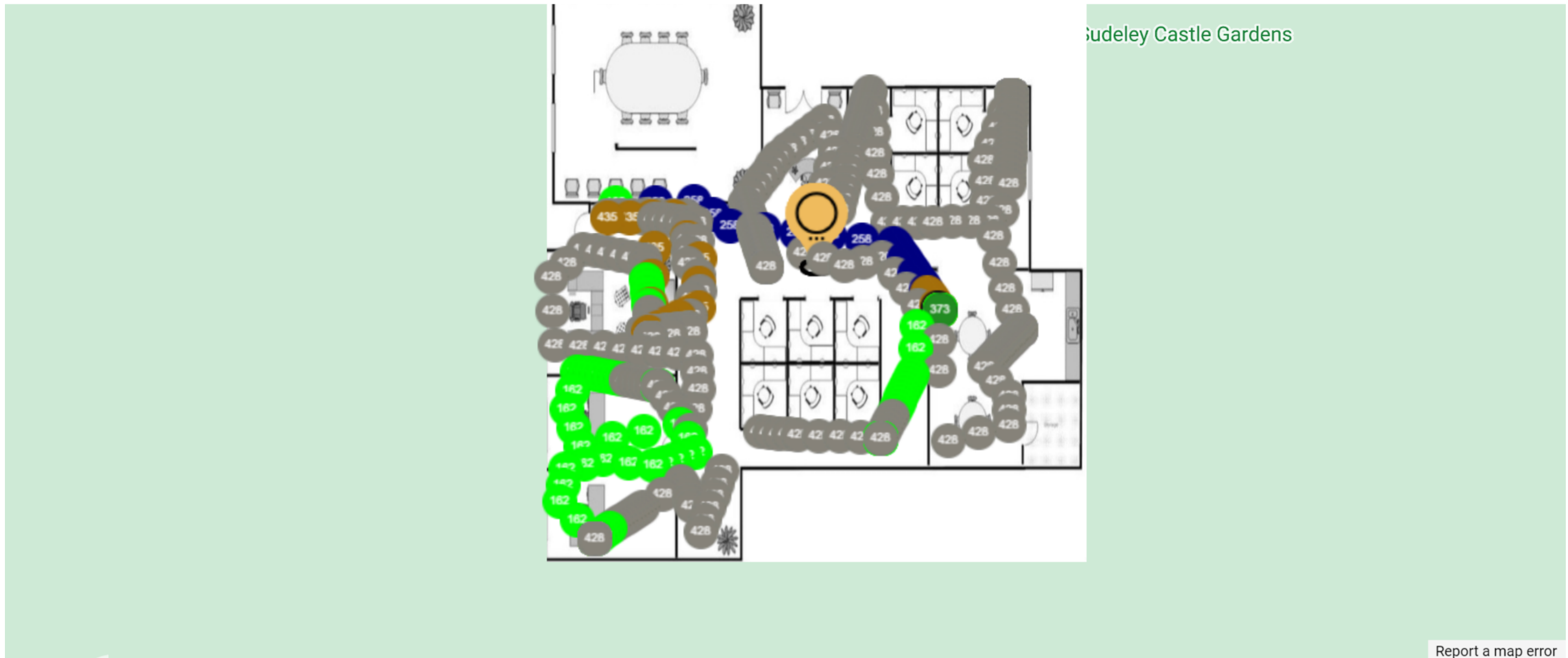

ItePCI KPI statistics per mobile operator for 40445_AIRTEL

PCI	Airtel (40445)
162 - PCI	15.5786 % (count : 105)
242 - PCI	0.1484 % (count : 1)
258 - PCI	4.0059 % (count : 27)
373 - PCI	0.1484 % (count : 1)
428 - PCI	74.4807 % (count : 502)
435 - PCI	5.6380 % (count : 38)
Total Geo samples	674

Floor Plan Name : castle2 Floor ID : 1

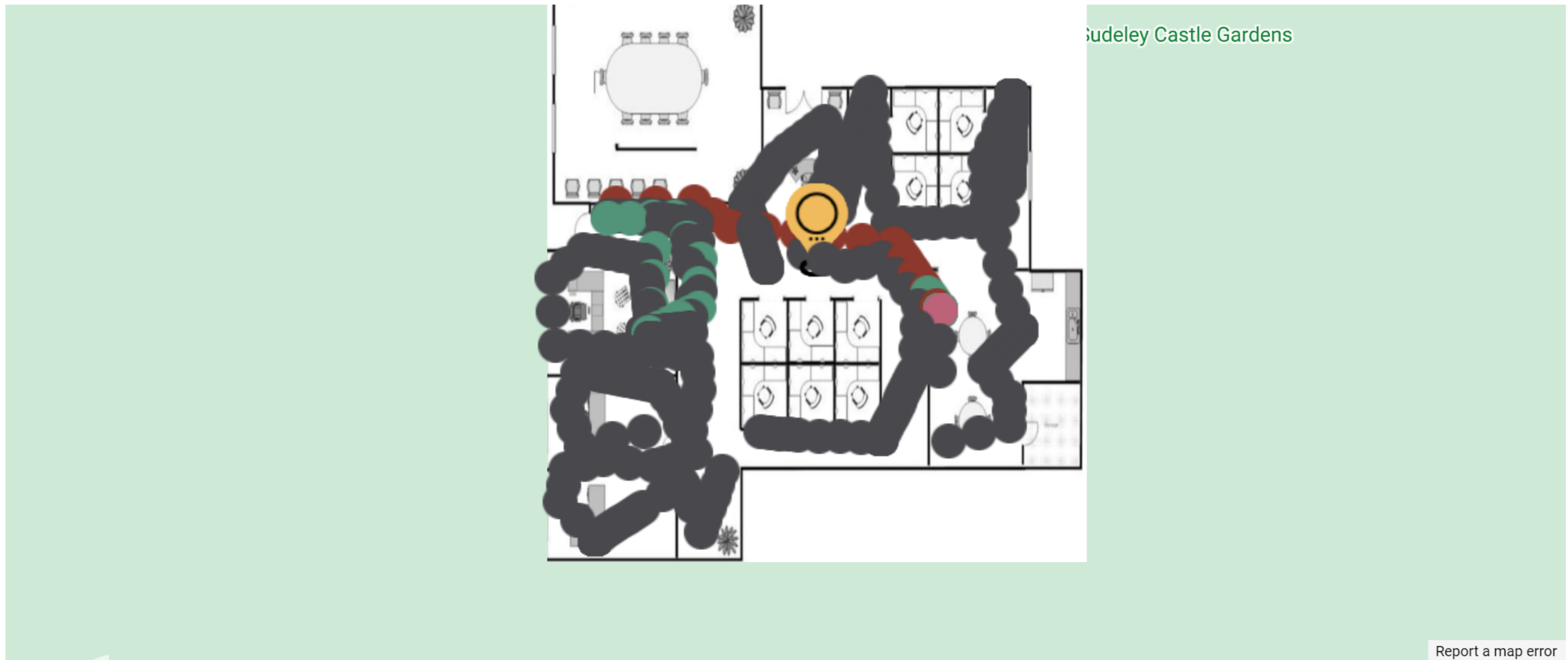

Arfcn KPI statistics per mobile operator for 40445_AIRTEL

Arfcn	Airtel (40445)
● 1301 - lteEARfcn	88.4273 % (count : 596)
● 240 - lteEARfcn	6.9733 % (count : 47)
● 3626 - lteEARfcn	0.1484 % (count : 1)
● 39275 - lteEARfcn	4.4510 % (count : 30)
Total Geo samples	674

LTESNR view

LTESNR KPI statistics per mobile operator for operator 40445_AIRTEL



Floor Plan Name : castle2 Floor ID : 1

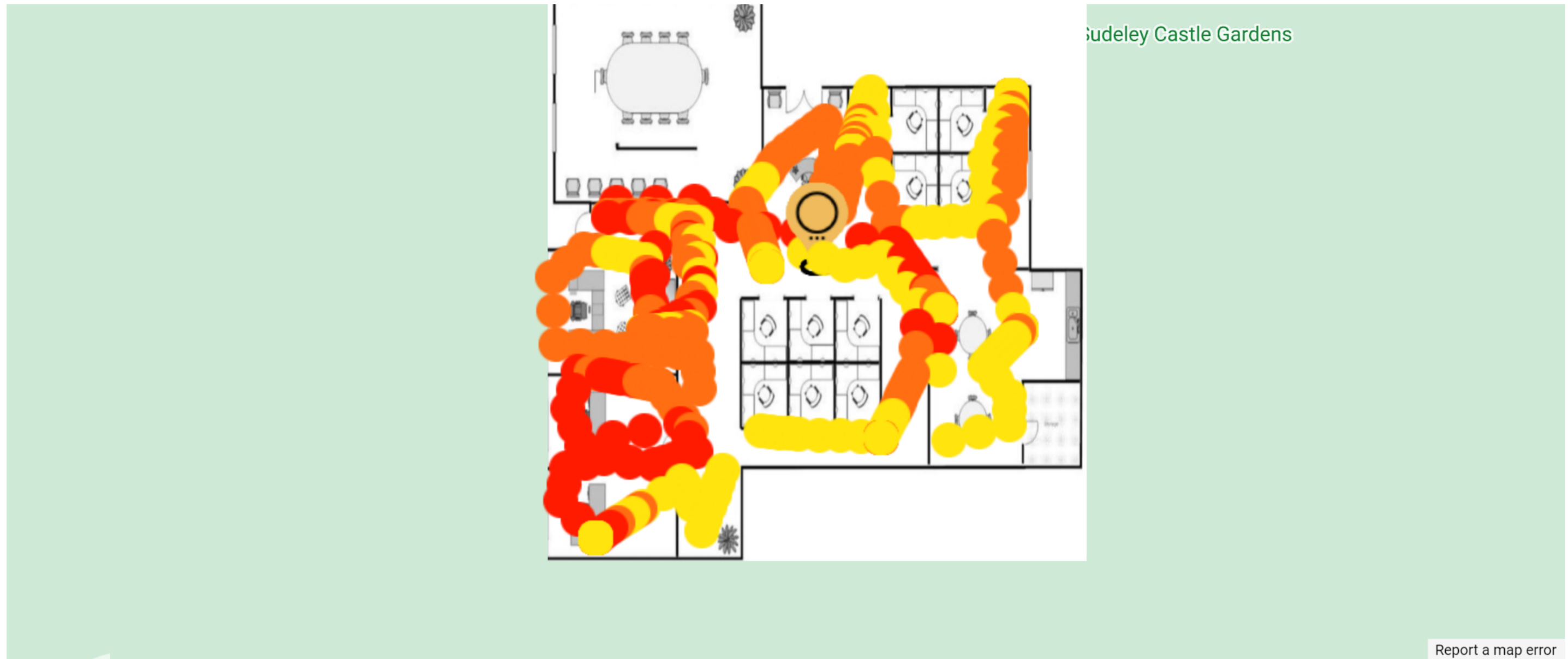

LTESNR KPI statistics per mobile operator for 40445_AIRTEL

lteSNR	Airtel (40445)
>= to 30dB	0 % (count : 0)
B/w 29dB to 18dB	0 % (count : 0)
B/w 17dB to 12dB	0 % (count : 0)
B/w 11dB to 5dB	33.9422 % (count : 223)
B/w 4dB to 0dB	50.6849 % (count : 333)
B/w -1dB to -20dB	15.3729 % (count : 101)
B/w -21dB to -31dB	0 % (count : 0)
<= -32dB	0 % (count : 0)
Total Geo samples	657